

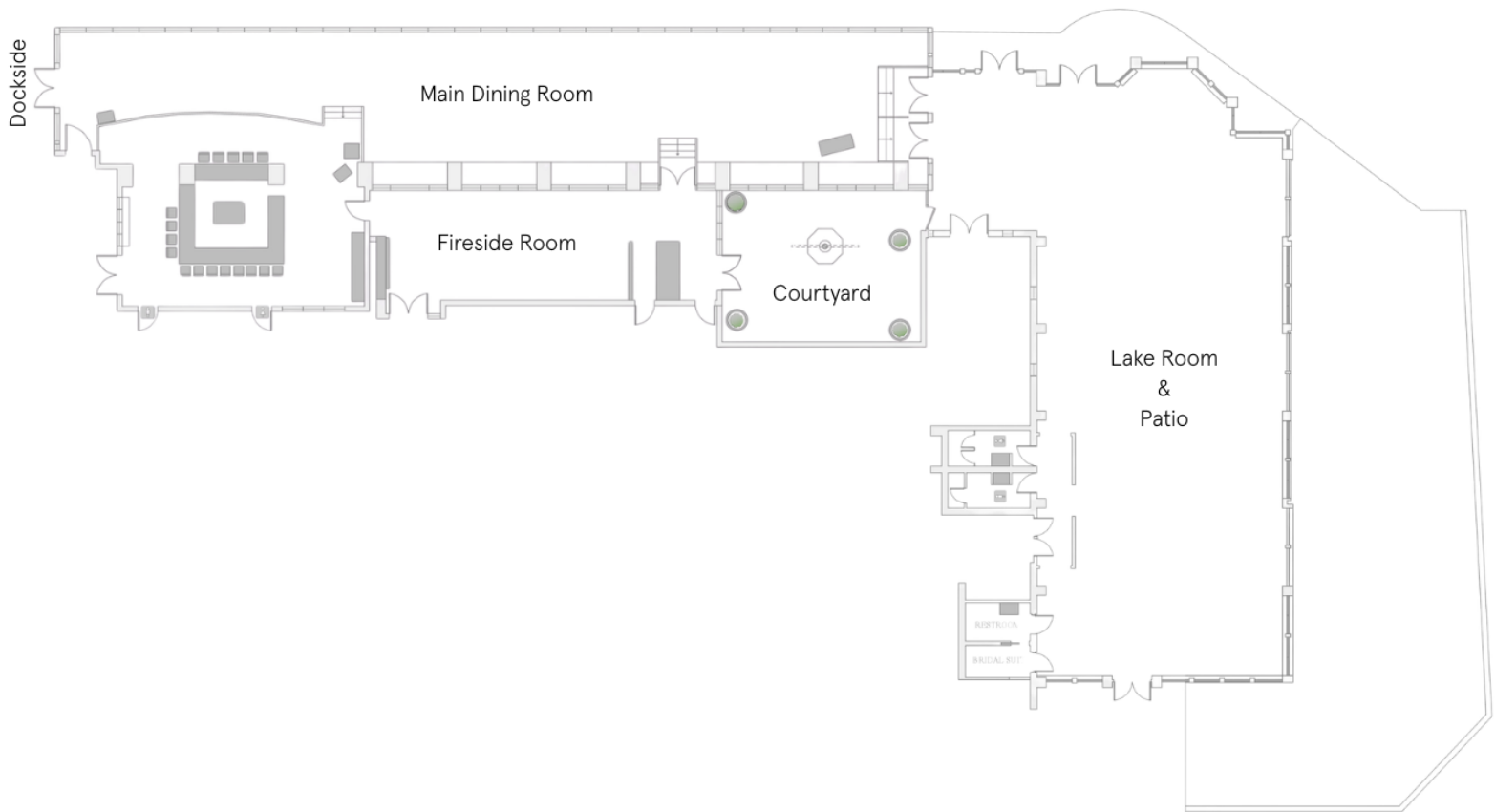

# THE BOATHOUSE

FLOOR PLANS

# FULL VENUE FLOORPLAN



# LAKE ROOM & PATIO

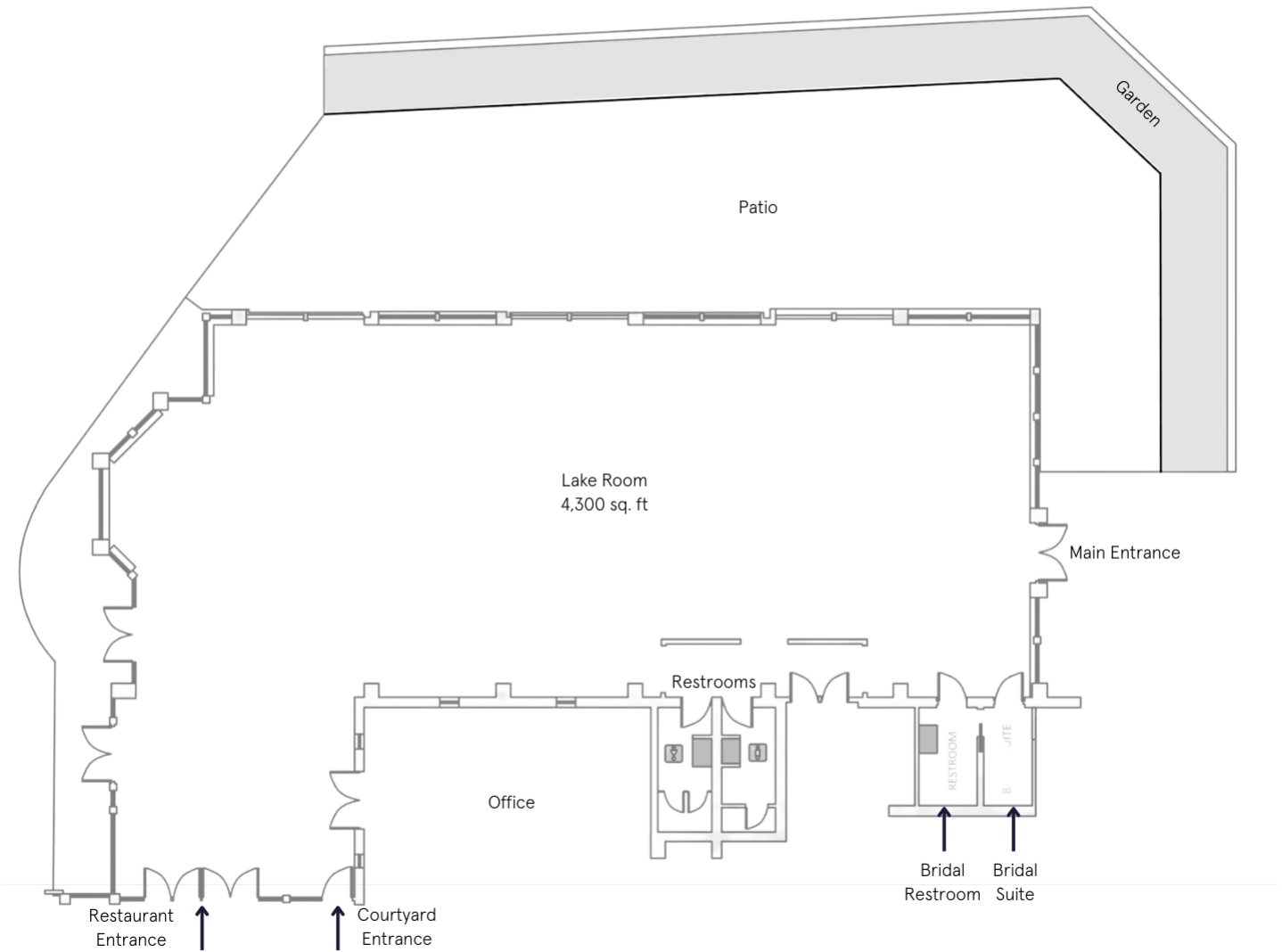

## CAPACITIES

|          |     |
|----------|-----|
| SEATED   | 200 |
| STANDING | 350 |
| THEATER  | 250 |



# FIRESIDE ROOM

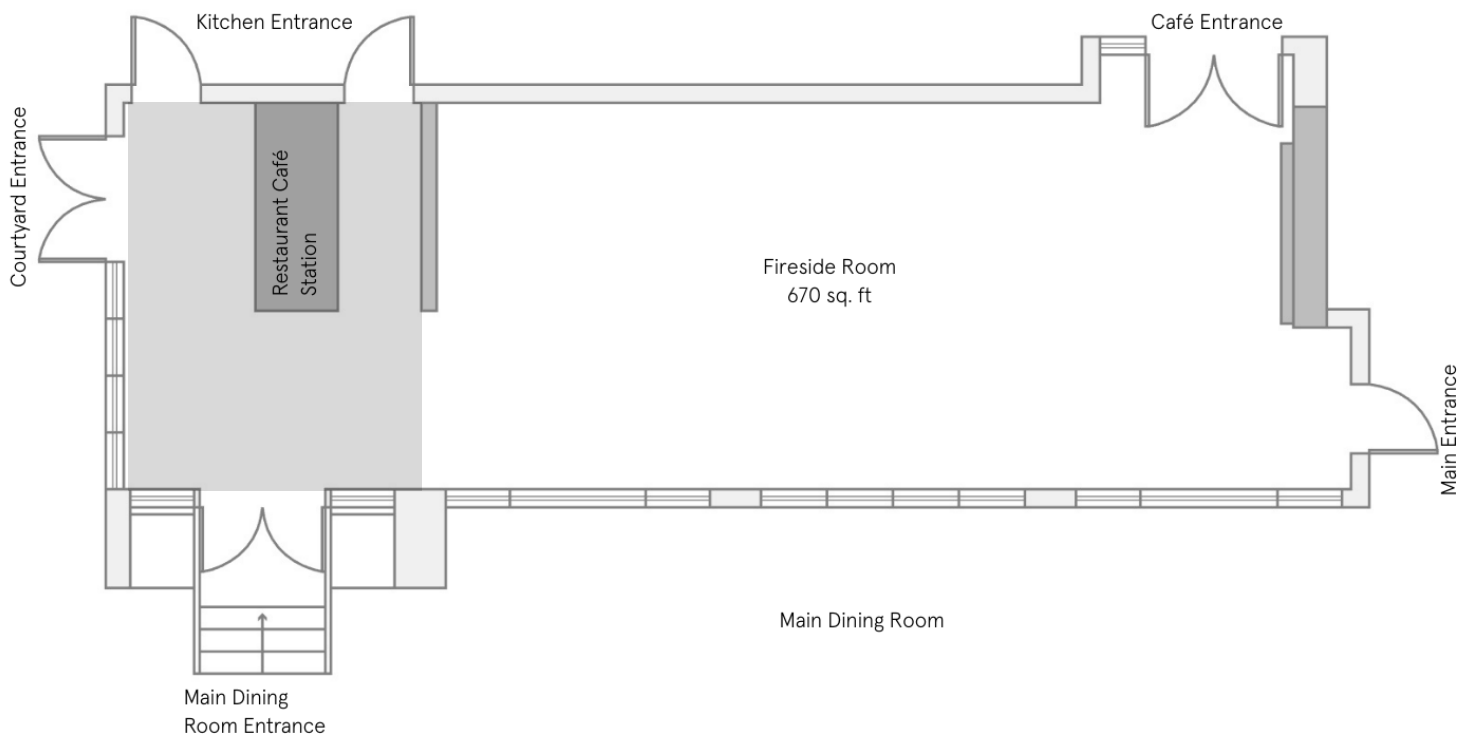

## CAPACITIES

|          |    |
|----------|----|
| SEATED   | 50 |
| STANDING | 50 |



# MAIN DINING ROOM

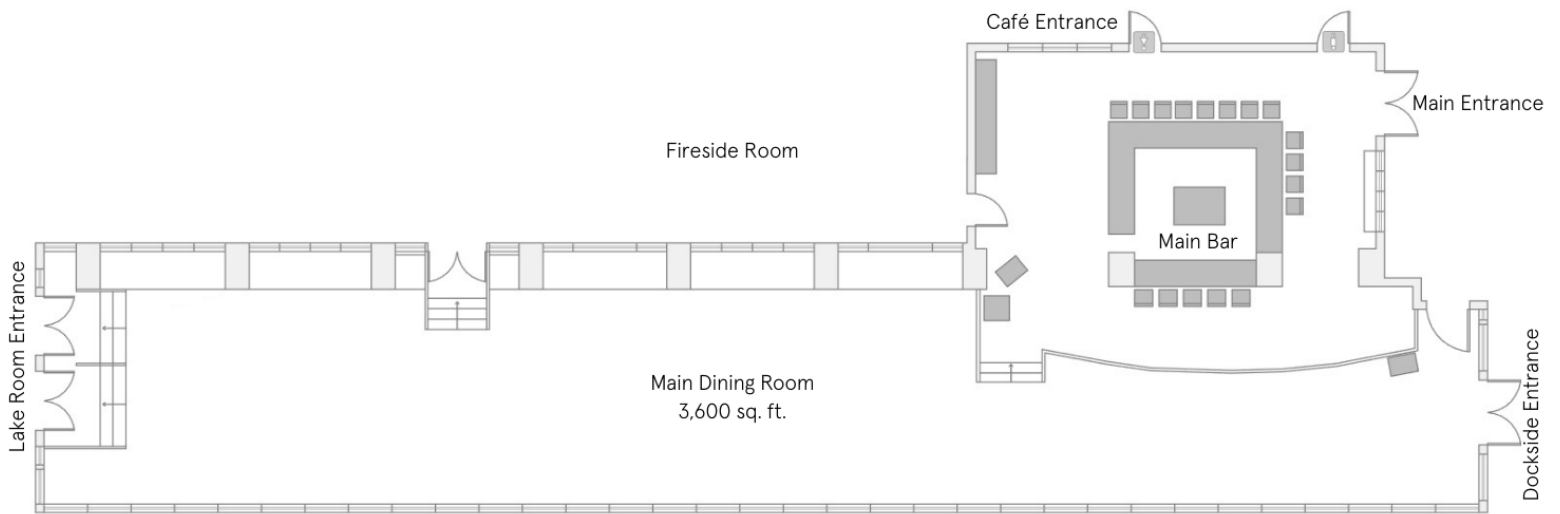

## CAPACITIES

|          |     |
|----------|-----|
| SEATED   | 100 |
| STANDING | 150 |



# DOCKSIDE

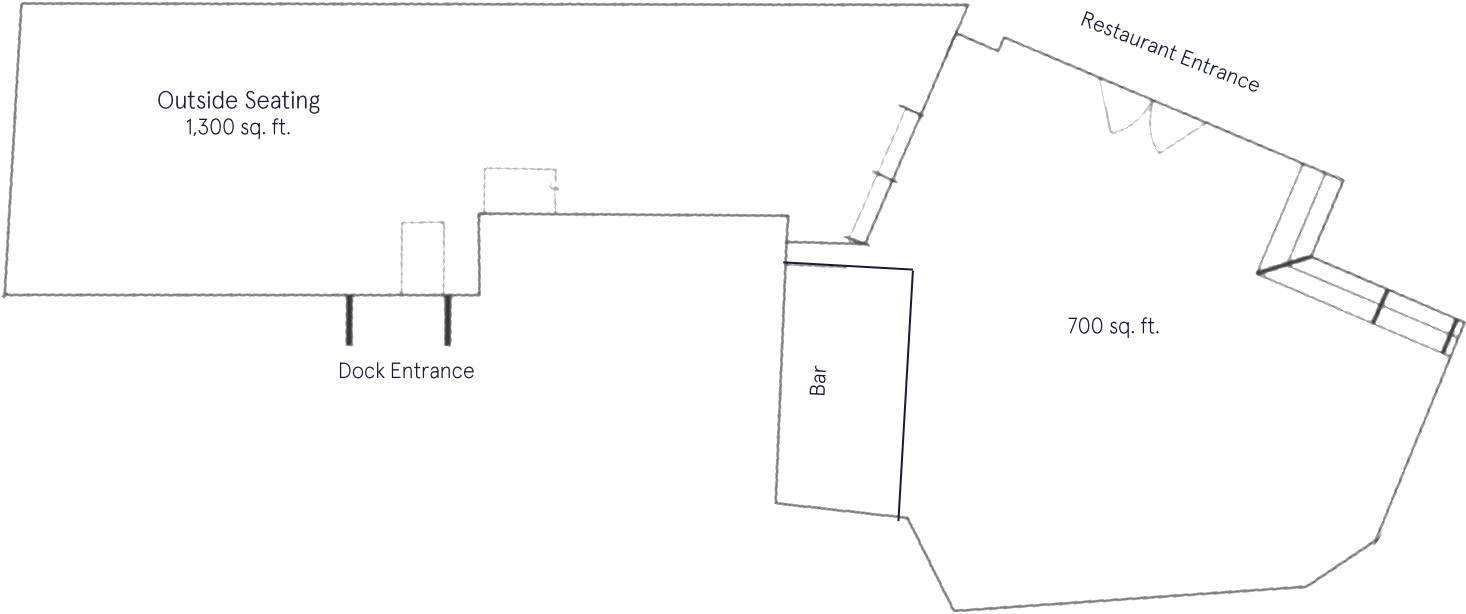

## CAPACITIES

---

|          |     |
|----------|-----|
| SEATED   | 80  |
| STANDING | 100 |

---



# VENUE AMENITIES

## LAKE ROOM FURNITURE

|                            |     |
|----------------------------|-----|
| 72" ROUNDS (MAX 12 GUESTS) | 2   |
| 60" ROUNDS (MAX 10 GUESTS) | 28  |
| 36" COCKTAIL TABLES        | 6   |
| 24" COCKTAIL TABLES        | 6   |
| 30" HIGH TOPS              | 12  |
| 72" HALF MOONS             | 2   |
| 60" HALF MOONS             | 2   |
| 6FT TABLES X 30"WIDE       | 9   |
| 4FT TABLES X 30" WIDE      | 12  |
| CHAIRS                     | 210 |
| INDOOR MOBILE BAR          | 2   |
| OUTDOOR BAR                | 2   |
| IRON PATIO TABLES          | 15  |
| IRON PATIO CHAIRS          | 30  |
| EASELS AVAILABLE           |     |

## FIRESIDE FURNITURE

|                         |    |
|-------------------------|----|
| 30X30 SQUARE TABLE      | 7  |
| 48X30 RECTANGULAR TABLE | 5  |
| CHAIRS                  | 50 |
| BANQUETTE SEATING       | 9  |

## TABLEWARE

|           |  |
|-----------|--|
| GLASSWARE |  |
| FLATWARE  |  |
| CHINA     |  |
| LINEN     |  |

## CATERING

Legends Global Hospitality  
(In-House Catering)

## VENDORS

Preferred partners list available.

## DESIGN

A clean, neutral, and classic style that feels timeless and effortlessly blends with Central Park's natural beauty.

## SOCIAL

@nycboathouse

